

# SC 700-T

## Touch Screen RFID Time & Attendance Terminal



The SC700-T is an RFID time & attendance terminal with 3" TFT LCD. Its color display and touch screen make the menu operation extremely comfortable and easy. Adopting ZK core board, its identification is very fast and reliable. It can also control the door access and connect with 3rd party electric lock, door sensor, and exit button, etc. Slim and elegant design makes the SC700-T more applicable to different type of offices.

---

### Feature

- 3" TFT color display and touch screen
- Elegant ergonomic design
- Easy operation
- Time attendance and access control functions
- Stores up to 30,000 cards and 100,000 records
- Optional Mifare card module.
- Access control interfaces for 3rd party electric lock, door sensor, exit button and alarm
- Multi-language available

# Specifications

Display	3-inch Touch Screen
ID Card Capacity	30,000
Log Capacity	100,000
Communication	TCP/IP, USB host
Standard Functions	ID Card, Automatic Status Switch, T9 Input, 9 Digit User ID, Multi-verification Method, 3rd Party Electric Lock, Door Sensor, Exit Button, Alarm, Self-Service Query, Work Code, DST, Scheduled-bell, Short Message.
Optional Function	Mifare Card, Wi-Fi
Power Supply	DC12V 1.5A
Verification Speed	≤1S
Operating Temperature	0 °C-45 °C
Operating Humidity	20%-80%
Dimensions	104.7 × 160 × 36 mm (L × H × D)

## Configuration

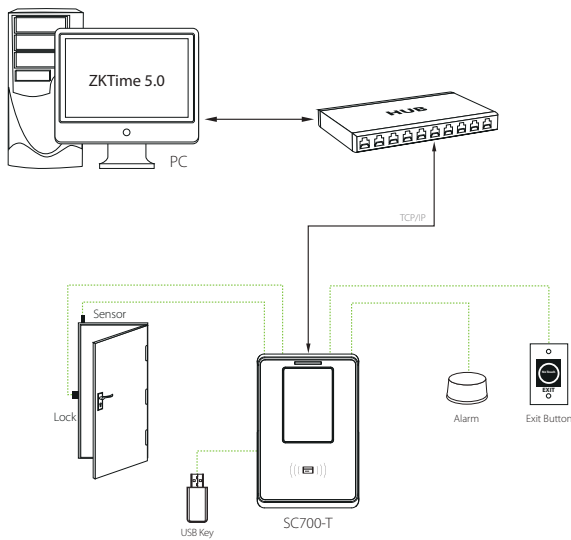

## What's in the Box

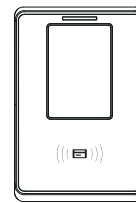

SC700-T

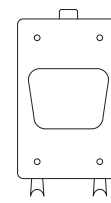

Back Plate



Mounting Paper

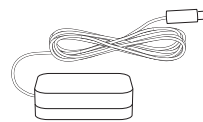

Power Adapter



Screws and Holders



ZKTeco Inc.  
E-mail: [sales@zkteco.com](mailto:sales@zkteco.com)  
[www.zkteco.com](http://www.zkteco.com)

© Copyright 2014. ZKTeco Inc. ZKTeco Logo is a registered trademark of ZKTeco or a related company. All other product and company names mentioned are used for identification purposes only and may be the trademarks of their respective owners. All specifications are subject to change without notice. All rights reserved.

